

Installation guide

for OmniClad Ribbed
Panel Assemblies



Welcome

Lenmak Exterior Innovations Inc. is one of North America's most advanced manufacturers in exterior architectural solutions, light gauge pre-finished metal panels, and state-of-the-art aluminum and steel cladding, insulated back panels, roofing, and flashing based out of Edmonton, Alberta, Canada.

Introduction

This instructional guide for OmniClad Ribbed is intended for experienced professionals with a background of installing siding, soffit and metal cladding systems. All Lenmak products should always be installed by a professional.



Prior to the installation of OmniClad Ribbed, ensure that a water-resistive barrier is installed correctly to the manufacturers' instructions.

Flashing

Flashing shall be installed in such a manner to prevent moisture from entering the wall or to redirect that moisture to the exterior. Flashing shall be installed at the perimeters of exterior door and window assemblies, penetrations and terminations of exterior wall assemblies, exterior wall intersections with roofs, chimneys, porches, decks, balconies and similar projections and at built-in gutters and similar locations where moisture could enter the wall. Flashing with projection flanges shall be installed on both sides and the ends of copings, under sills and continuously above protection trim.

(IBC 2015: 1405.4 Flashing).

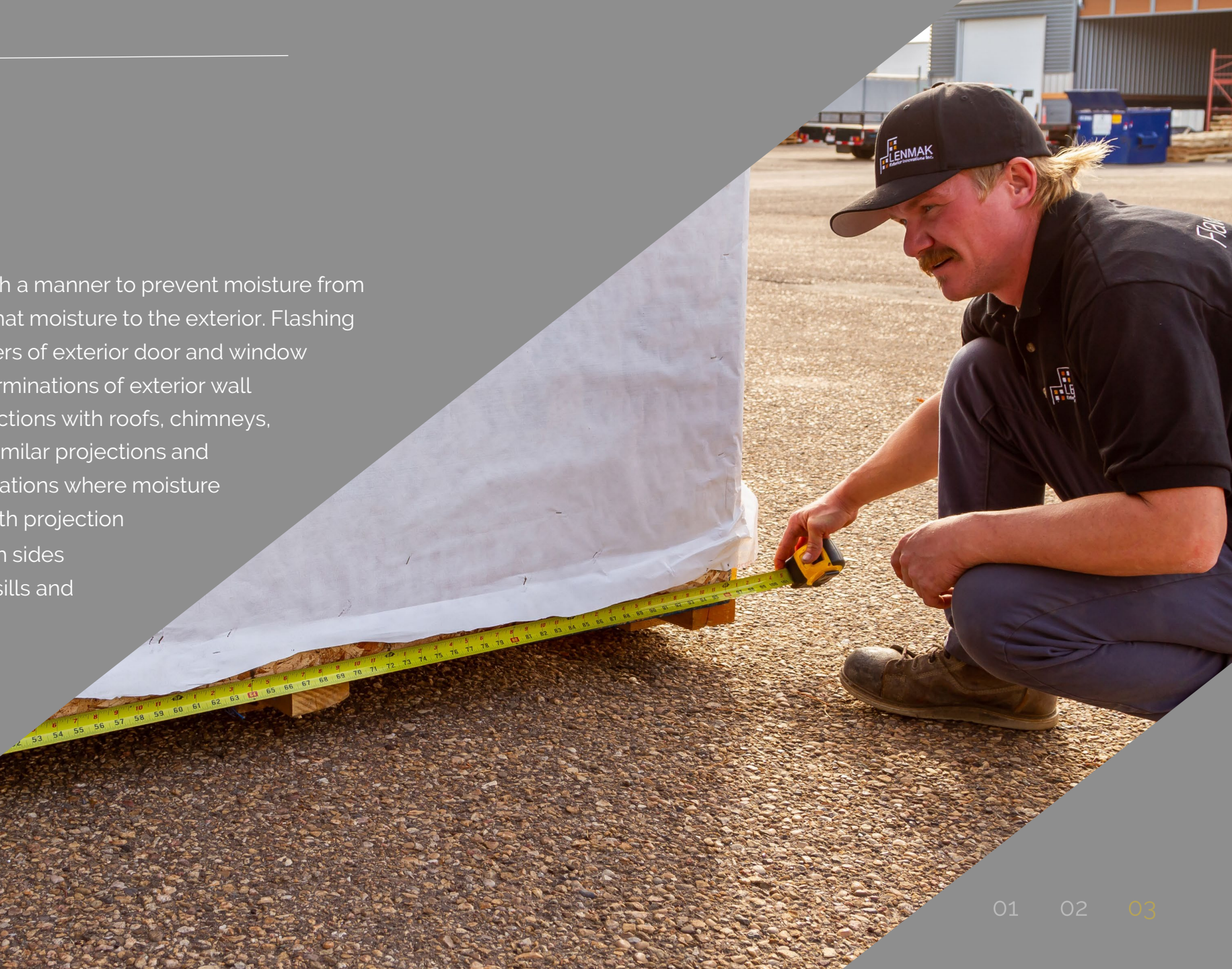

DRIP FLASHING

CORNER TRANSITION

Measure remaining length of the corner including the notch on the previous flashing.





DRIP FLASHING

CORNER TRANSITION.

Now take your last measurement and mark out your first line on the nail flange of the drip flashing. Using a speed square, draw a line 45° towards the hem. Draw another 45° line from the hem back towards the nail flange.





Corner TRANSITION.

Then create a line at this end and
mark out your centre line.



DRIP FLASHING

Corner Transition



Cut and Fold

1. Cut out one side.
2. Cut along 45° line.
3. Fold Tabs at remaining lines.

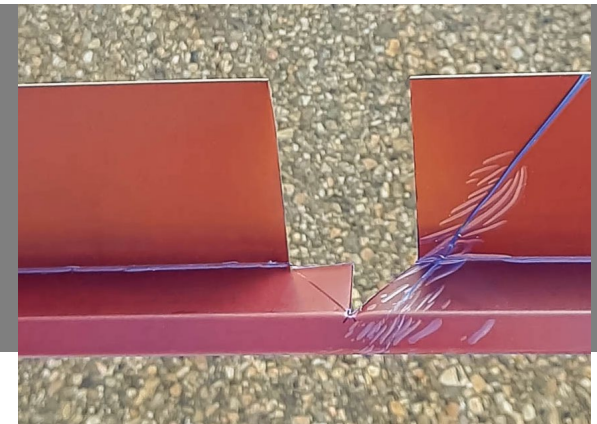
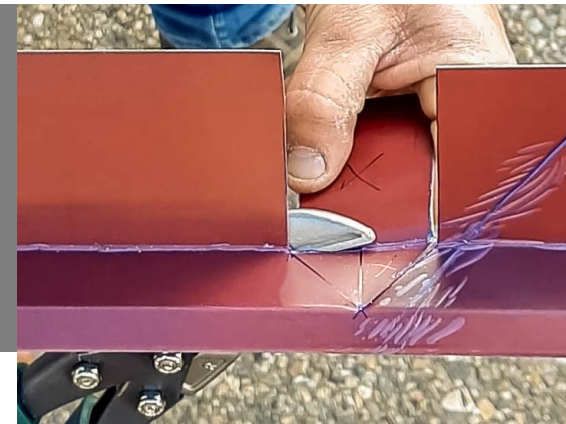



Align

Align cut edge with edge of wall and hold drip flashing in place with a screw.



Level

Ensure that drip flashing is level and install more screws to fix it in place.



Bend

Using folding pliers, grip the hem and bend the corner of the drip flashing toward the wall, tucking the tab under the previously secured leg.



Adjust

Adjust the bent drip flashing to the wall and ensure it is level and neatly bent.



Secure

Secure the drip flashing to the wall with screws.



Drip Flashing Corner Transition.



Installed Drip Flashing





2-piece Corner Base – Installation

Secure 2-Piece Corner Base Flashing with screws. Ensure 45° pocket is inline with the corner of the building.

LOWER 2-piece BASE J -

Starter Install.

The first row of panels will engage this starter to secure the bottom of the panel. The bottom of each subsequent panel will lock into the top hook of the previous panel.

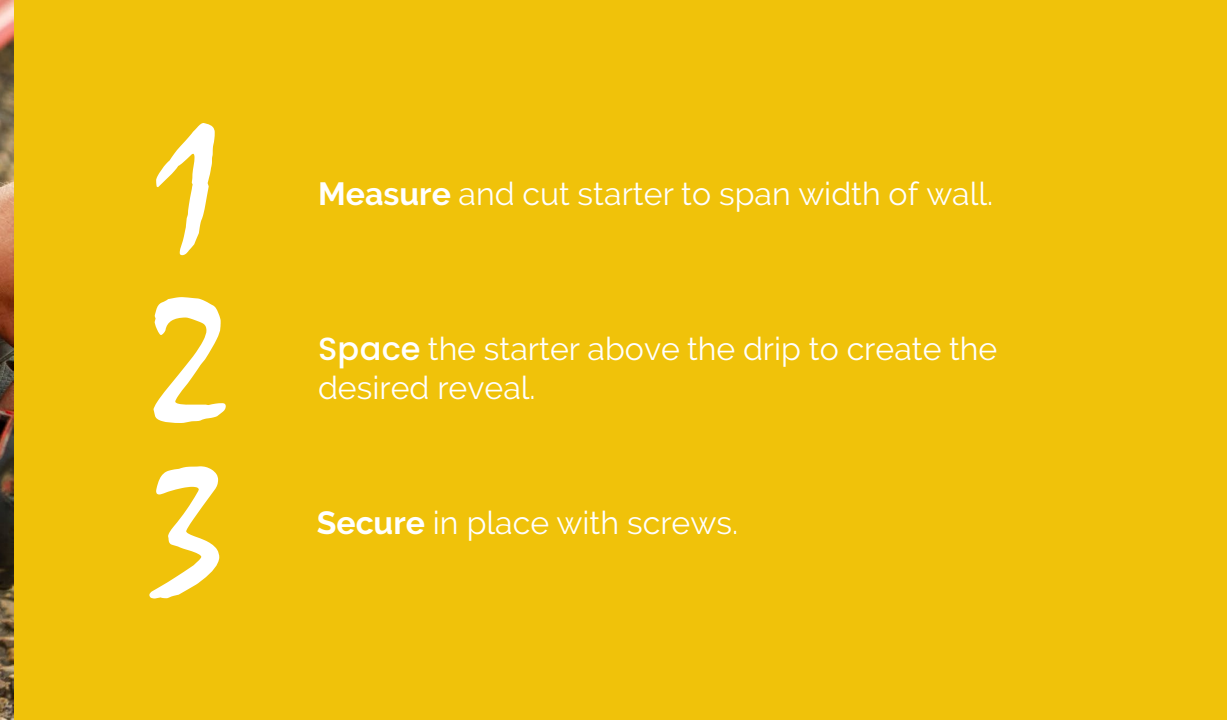

1

Measure and cut starter to span width of wall.

2

Space the starter above the drip to create the desired reveal.

3

Secure in place with screws.

Prepare the panel

Peel the laminate from the panel that will be installed next. If it is preferred to leave the laminate on the panel until after installation, peel back the edges to keep them clear of the locking surfaces.

Note: Laminate and its adhesive will break down when exposed to UV, making it difficult to remove from a panel without leaving residue. It should be promptly removed following panel installation.



PANEL INSTALL -

Horizontal.

Engage the panel onto the starter strip and secure the panel with clips. Continue to install clips along the panel and fasten in place (maximum 24" clip spacing), while ensuring that the panel remains level/plumb.



Second Panel Layer

Lock the bottom of the new panel into the hook of the panel below.

1

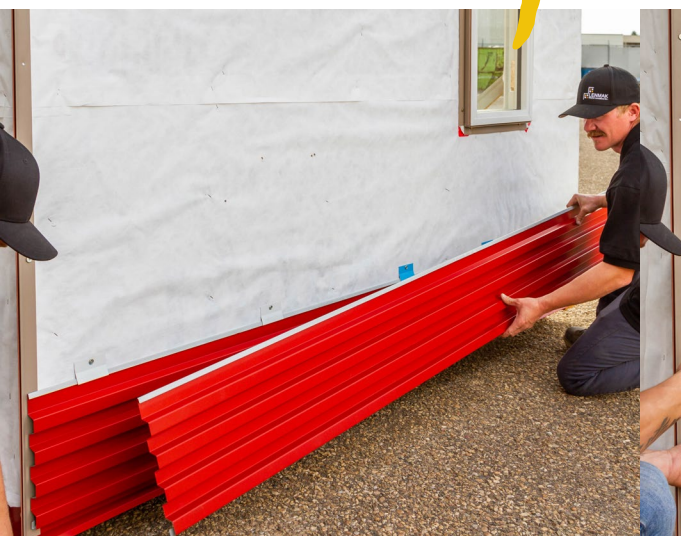

2

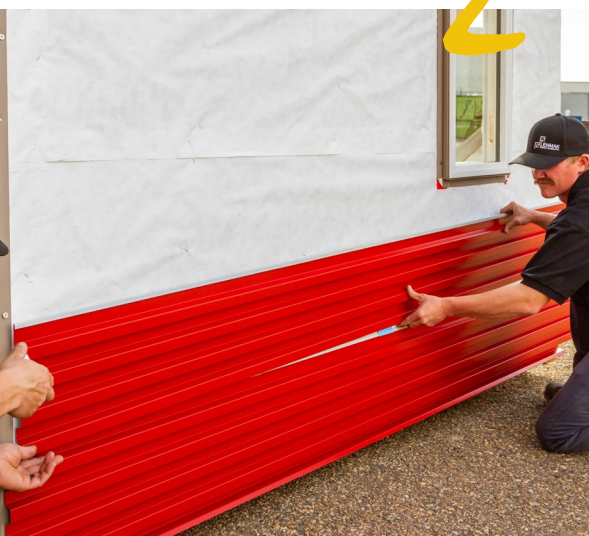

3

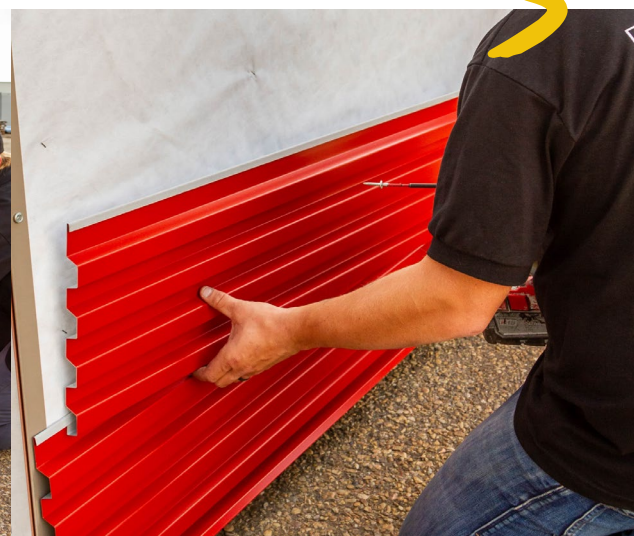

4





Apply even pressure to subsequent clips to ensure that panels are installed level.



Second Panel Layer

Note: when locking the panels to and trying to maintain the rib spacing, the panels may allow you to create a slightly larger rib gap when pulling up too hard on the lock. A spacer will help keep the panels rib spacing consistent.

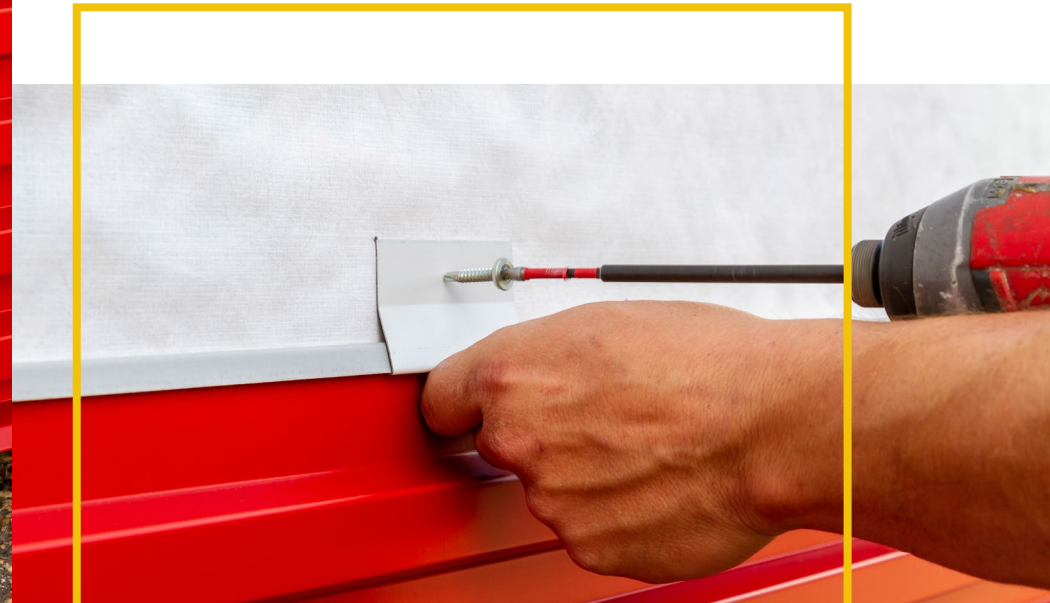

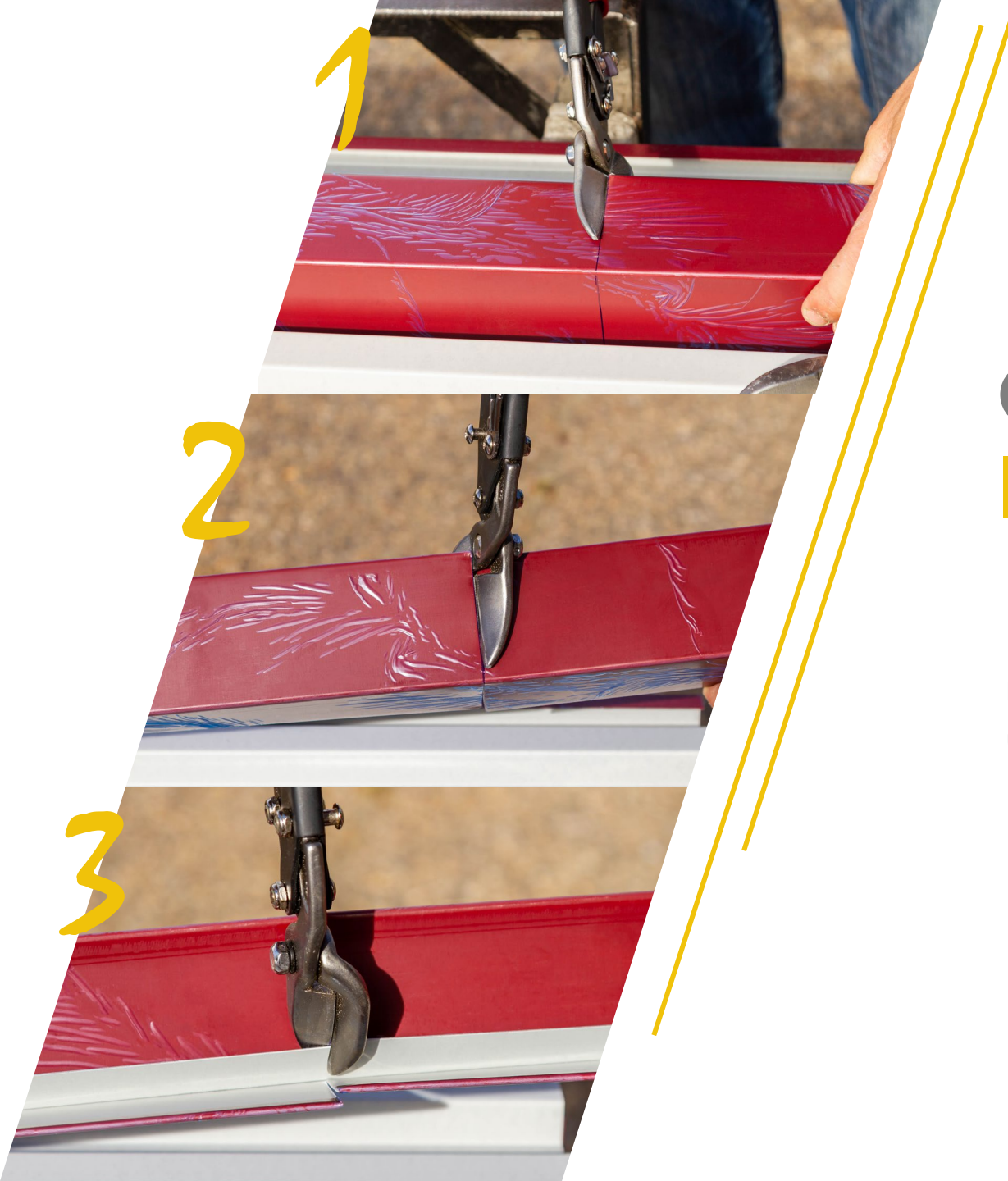

CORNER CAP INSTALL

Measure and Cut

Measure from the drip cap to the bottom of the soffit. Cut to length using snips or a cold cut metal blade.

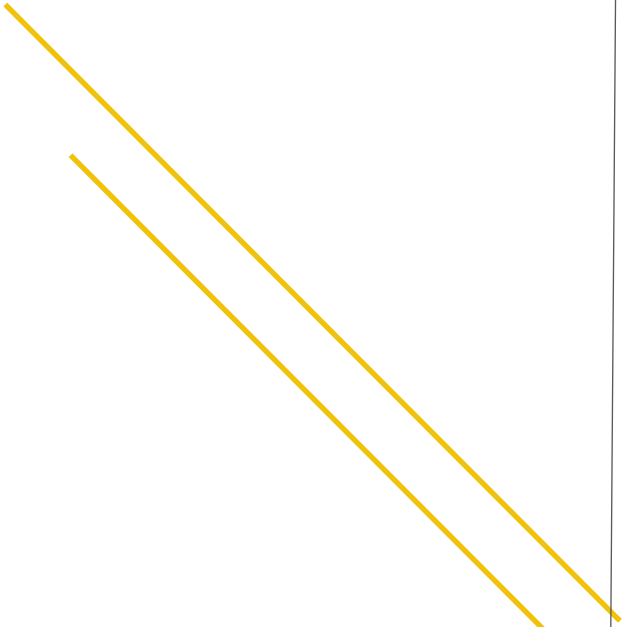



Remove Laminate.

Peel the laminate from the cap. If desired, the laminate can be left on the exposed surfaces until after the installation is complete. However, ensure that laminate is removed from the locking leg and the back side of the cap to assist with final removal after installation.

4

Cut and Separate.

When cutting the cap to length, be careful not to deform the locking leg. Keeping this leg straight will assist with installation. Straighten after cutting if necessary.



CORNER INSTALL.

Start by engaging the corner in one end and slowly work your way across. Tap in place with appropriate tools so as not to mark the painted surface.





Corner Install.

The **finished corner** should cover both the panel and the J-trim.



Vertical Installation

TRIM INSTALL

2-piece Corner Base Installation

- 1. Measure.** The length from the drip flashing to the underside of the soffit.
- 2. Cut.** Using snips or a cold cut saw blade. Never use abrasive cut off wheels with metal flashing.
- 3. Secure.** Secure 2-Piece Corner Base Flashing with screws. Ensure 45° pocket is inline with the corner of the building.



Lower J-trim BASE INSTALL.

Optional, depending on desired look.

1
2
3

Measure and cut 2-piece J-trim base.

Drill a weep hole in bottom of J-trim base before installing.

Secure in place with screws.



UPPER 2-PIECE J BASE

TRIM INSTALL

Measure and cut the J-trim base to length. Any joints in the flashing can be butted together.

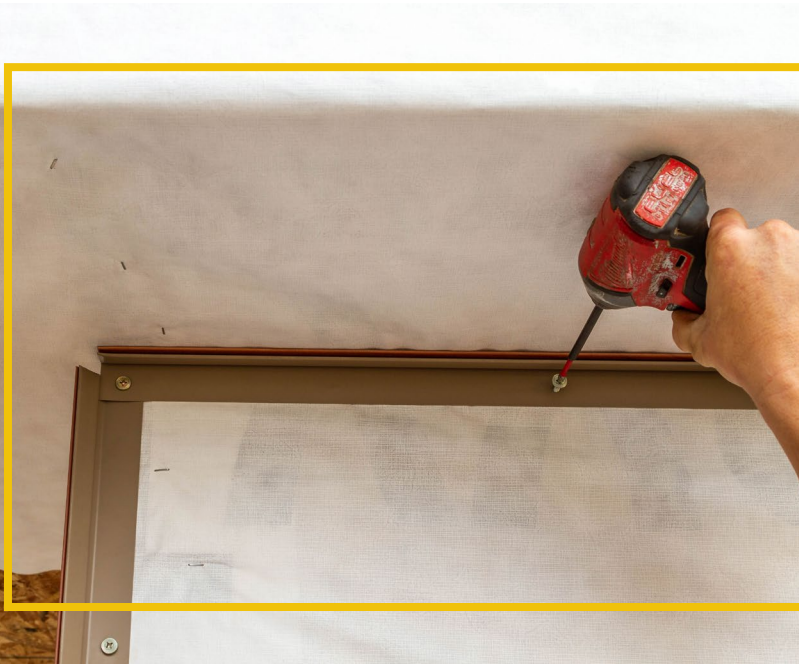

Starter Strip – Install.

Measure the length between the flashing for the starter strip and panels. Subtract $\frac{1}{4}$ "(6mm) for clearance.



- 1. Measure.** Measure back $\frac{3}{4}$ "(19mm) from edge of 2-piece Base flashing.
- 2. Level.** Before installing any more fasteners level the starter.
- 3. Pin.** Secure one end of the flashing with a #8 screw.
- 4. Fasten.** Secure with remaining screws.

Prepare Panel

Peel the laminate from the panel that will be installed next. If it is preferred to leave the laminate on the panel until after installation, peel back the edges to keep them clear of the locking surfaces.

Note: Laminate and its adhesive will break down when exposed to UV, making it difficult to remove from a panel without leaving residue. It should be promptly removed following panel installation.

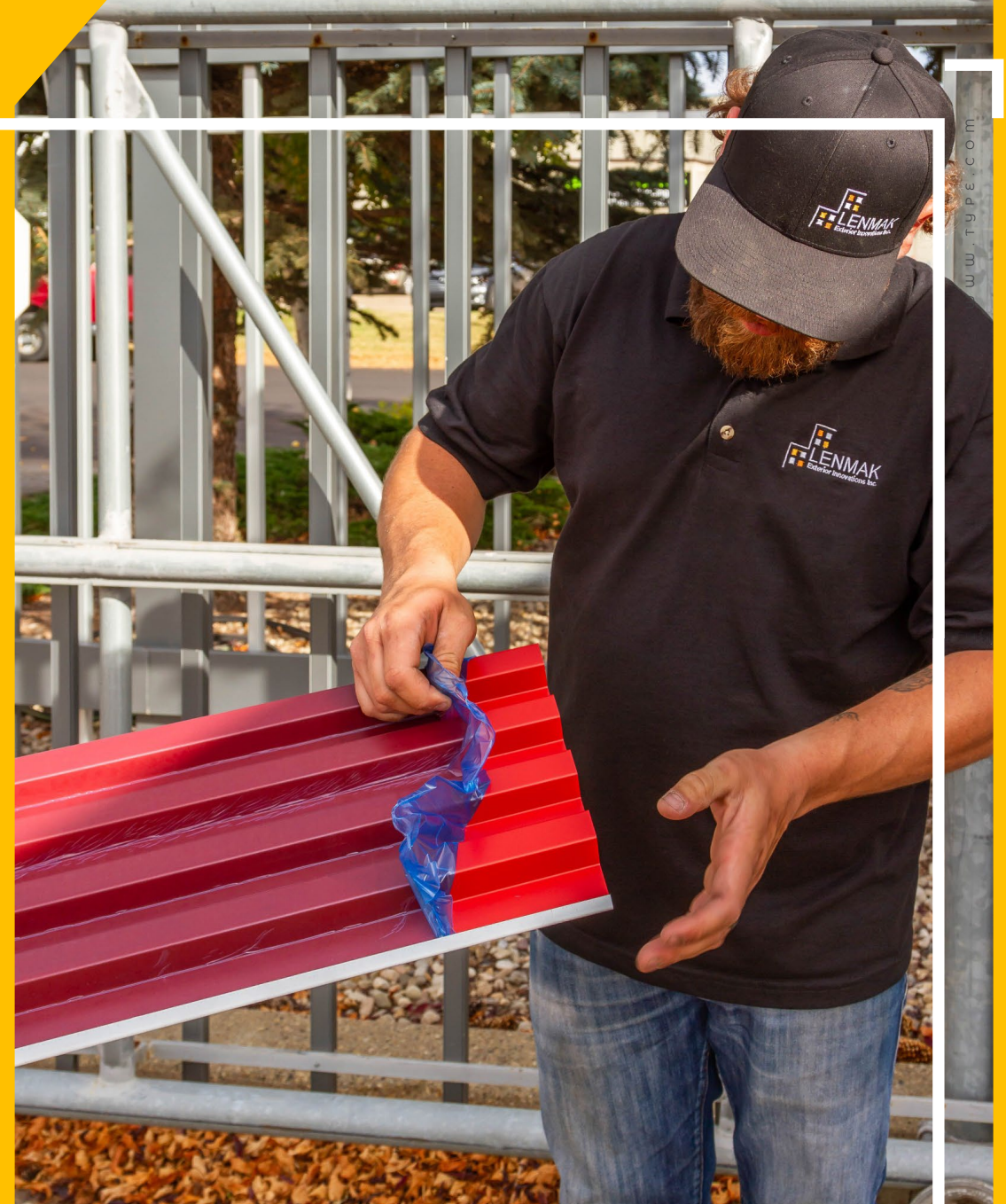



PANEL PREP - VERTICAL.

When using OmniClad Ribbed in a vertical application it is recommended to top hang the panel with a screw directly through the leg at the top of the panel.

Notch

In order to keep the fastener hidden, notch out the top of the hook to provide clearance for the fastener.



PANEL INSTALL Vertical.



Engage the panel into the starter and pin the top of the panel with a screw. Check if the panel is level and secure with clips. Maximum clip spacing is 24" OC.

Panel Install



Bring Second Panel

Set the bottom of the second panel on the J-base or drip flashing.



Align Lock

Align the locking elements on the two panels and engage lock.

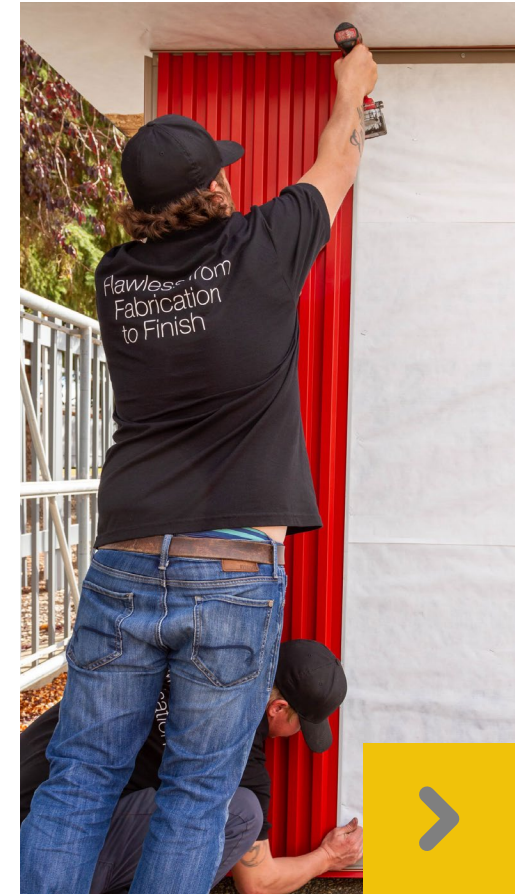

Lift and Fix

Lift panel into place, ensure positive lock engagement and install top screw.

Vertical Panel install.

When locking panels together to maintain the rib pattern, cut spacers and place them in the panel joints to keep panels parallel when securing with clips.



PANEL & VERTICAL

Install

Continue to top hang each panel and then secure with clips (24" spacing max).





2-PIECE J-TRIM TOP

PREPARATION.

Cut the 2-piece J-trim top to length and cut an angled relief on the engaging leg at each end. Ensure that the angle is sufficient to prevent interference when installing the Top into the Base.



1



2



3



4

2-Piece J-trim Top Install

Push the 2-piece J-trim top into its base. Then using a rubber mallet, gently tap it tightly into the lock.

Flashing Details

When using the 2-piece corner, install all other 2-piece J-trim caps before installing the corner cap.

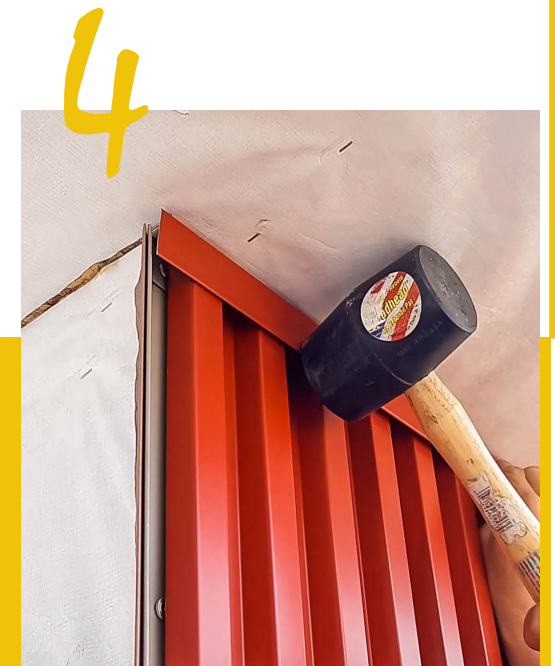
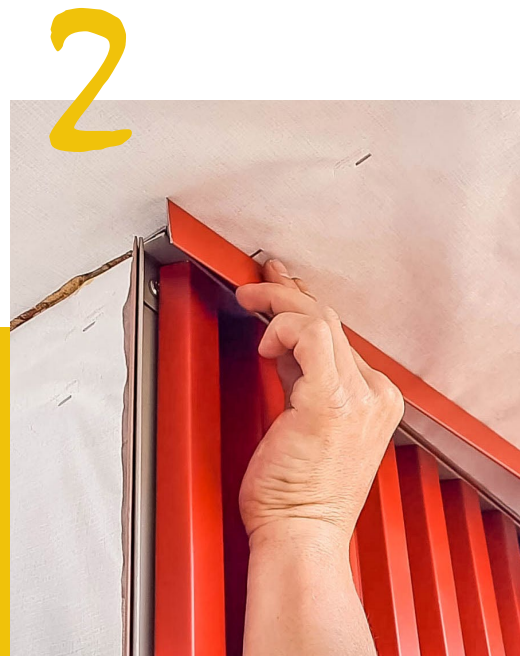

Corner Install



Cut to length

Cut the corner cap to length and align the engaging leg into the base at the top.



Fit by hand

Begin pressing the corner into the base, making sure to align the corner vertically.

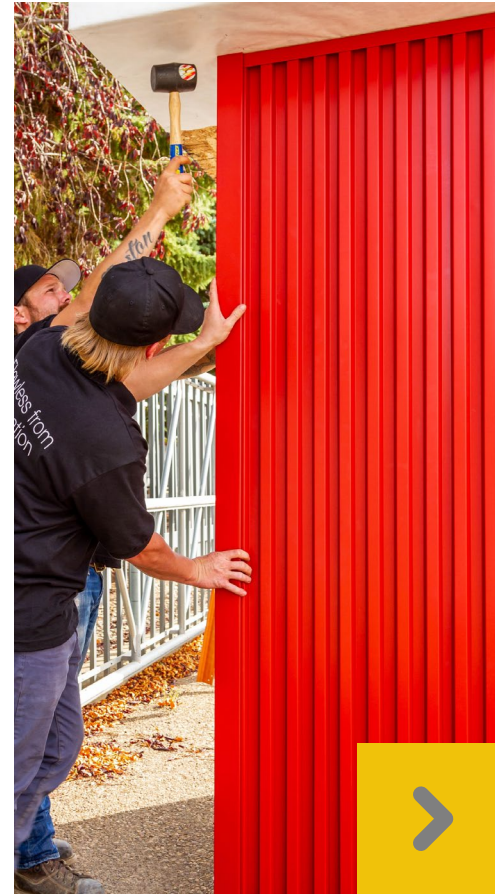

Press in place

Press the corner in place with your hands and verify vertical alignment before proceeding to the final step.

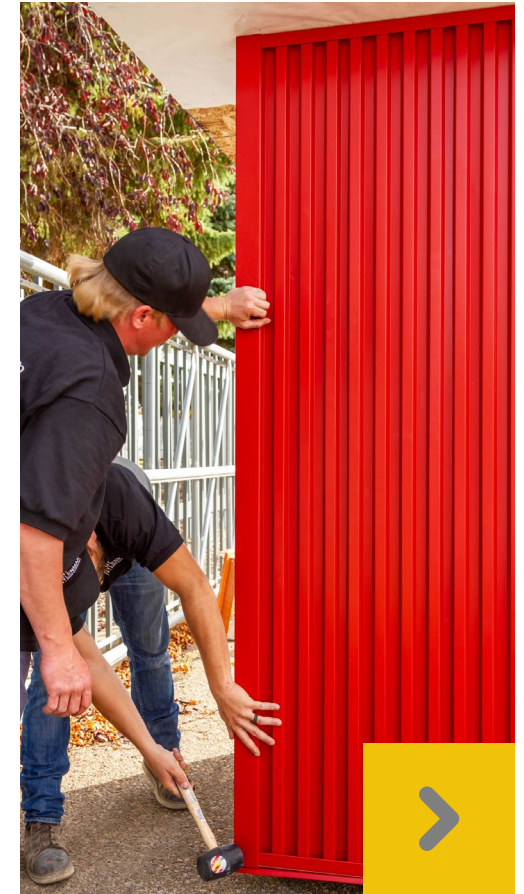

Firmly seat

Once you are sure of the alignment, gently tap the corner with a rubber mallet to fully seat it in place.



Get in Touch

We look forward to learning more about your project or custom metal needs.

Address



10404 – 176 Street Edmonton, AB
Canada T5S 1L3

Contact



(888) 451-5482 / (780) 451-5482



orderdesk@lenmak.com



www.lenmak.com

Follow us on

